

Vane Motors



High Torque, Low Speed Vane Motors

MHT SERIES 250-*1-30-S30

Std/F3 Seal Kit Cross Reference		Model	Ring	Bearing	Snap Ring	Shaft	Plug	Key
▲ Std 919873	F3 919874	MHT-250-N1-30-S30	343826	—	—	—	—	—
		MHT-250-R1-30-S30		310539	354386	345769	7074	306439

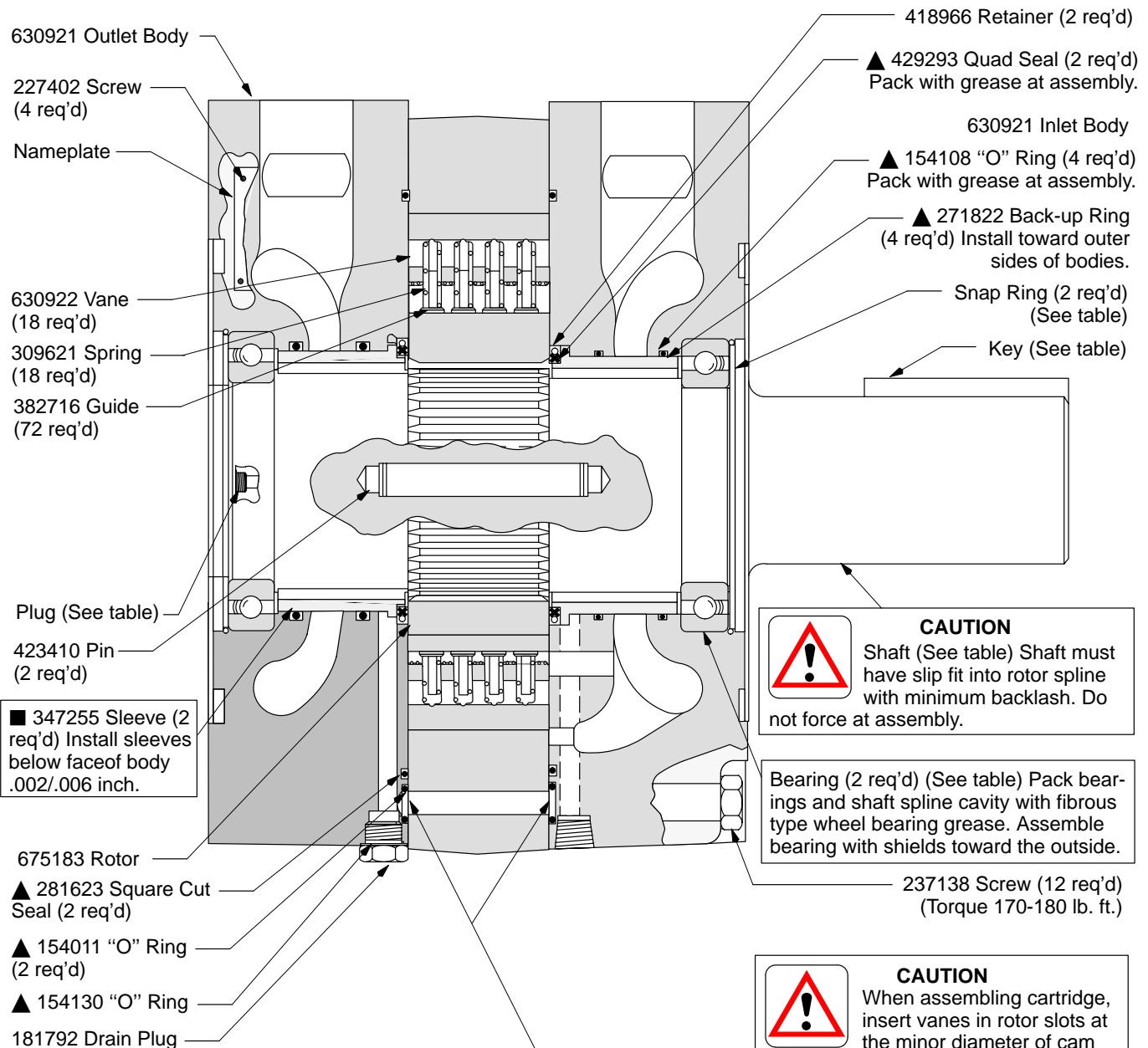
**CAUTION**

Shaft (See table) Shaft must have slip fit into rotor spline with minimum backlash. Do not force at assembly.

**CAUTION**

When assembling cartridge, insert vanes in rotor slots at the minor diameter of cam ring. Rotate cartridge one complete revolution prior to assembly with bodies. This prevents misalignment of springs and guides. Make sure the marked rotor tooth of each cartridge is in line before installation of shaft.

**WARNING**

Always wear safety glasses to prevent eye injury.

**CAUTION**

Ring (See table) Assemble both rings and spacer with case drain located as shown. Not rotated with hole at top.

Model Code

F3 - MHT - 250 - (*) 1 - 30 - S30

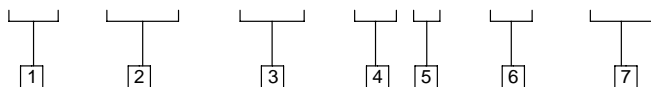

1 Seals

Multi-fluid capability, Viton seals

2 Model Series

High torque, low speed vane motor

3 Theoretical Torque in Lb. Ft. per 100 PSI Differential Pressure

4 Shaft

N - No shaft & bearings

R - Solid shaft

5 Shaft Options

Keyed shaft when provided

6 Design

7 Features

Quiet feature, low pulsation levels

For satisfactory service life of these components, use full flow filtration to provide fluid which meets ISO cleanliness code 18/15 or cleaner. Selections from pressure, return, and in-line filter series are recommended.