

# Vane Motors

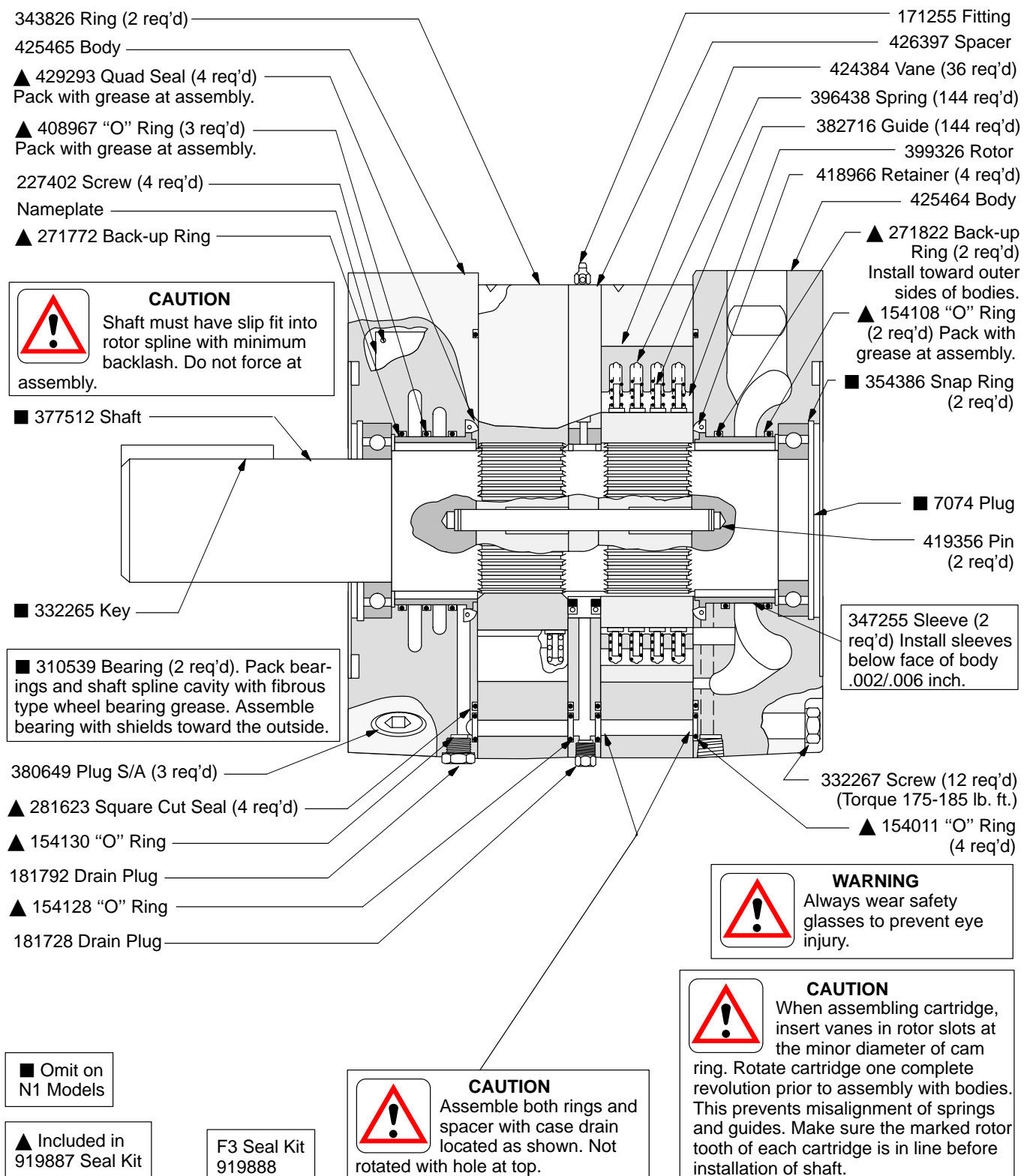

## High Torque, Low Speed Vane Motors

MHT SERIES 500/250/250-\*1-30-S27



## Model Code

---

**F3 - MHT - 500/250/250 - (\*) 1 - 30 - S27**

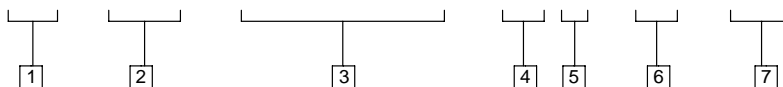

---

### **1 Seals**

Multi-fluid capability, Viton seals

---

### **2 Model Series**

High torque, low speed vane motor

---

### **3 Theoretical Torque in Lb. Ft. per 100 PSI Differential Pressure**

500/250/250

### **4 Shaft**

**N** - No shaft & bearings

**R** - Solid shaft

---

### **5 Shaft Options**

Keyed shaft when provided

### **6 Design**

---

### **7 Features**

Quiet feature, low pulsation levels

For satisfactory service life of these components, use full flow filtration to provide fluid which meets ISO cleanliness code 18/15 or cleaner. Selections from pressure, return, and in-line filter series are recommended.