

Vane Motors

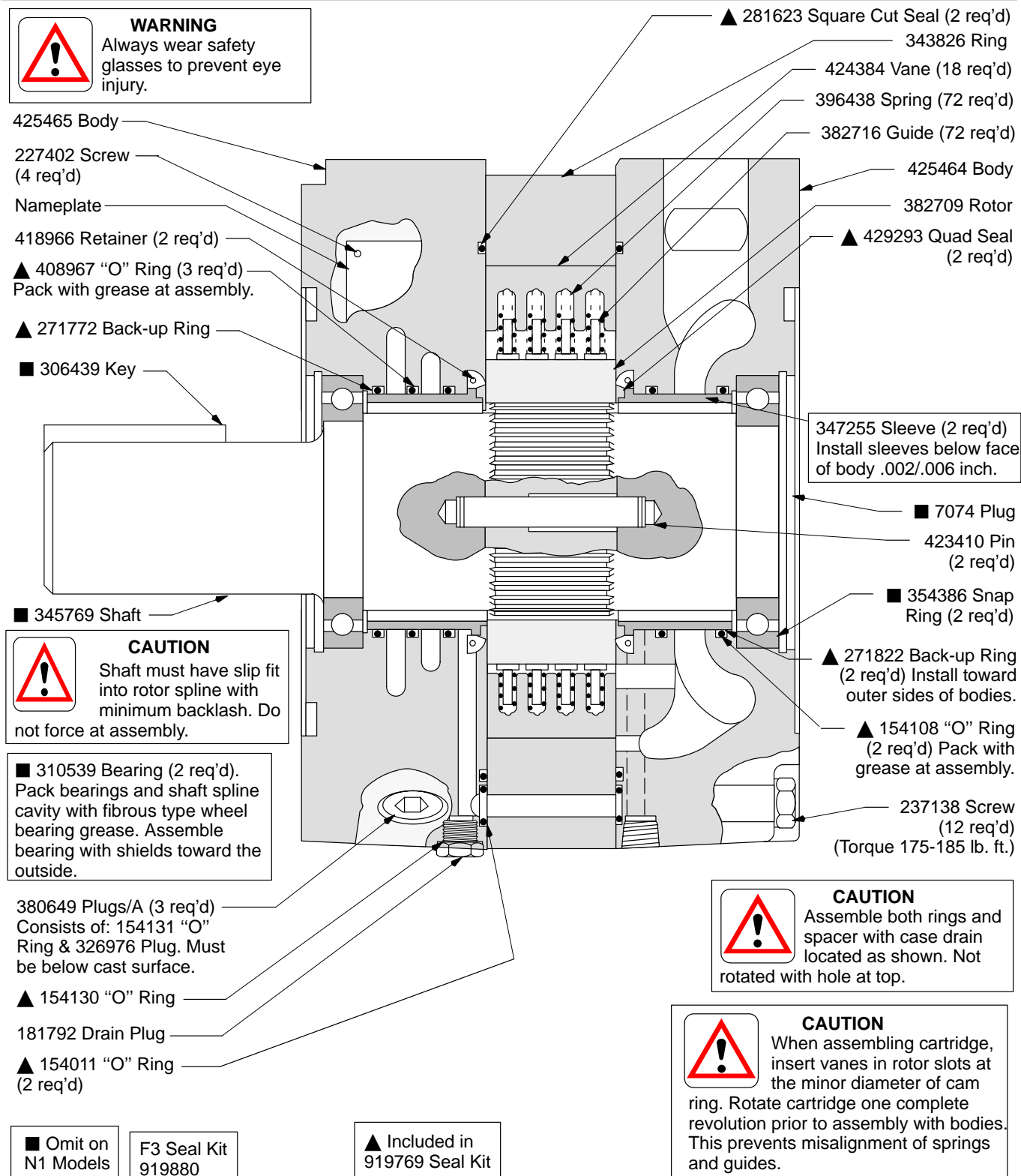

High Torque, Low Speed Vane Motors

MHT SERIES 250/125/125-*1-30-S27



Model Code

F3 - MHT - 250/125/125 - (*) 1 - 30 - S27

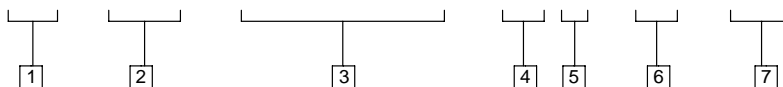

1 Seals

Multi-fluid capability, Viton seals

2 Model Series

High torque, low speed vane motor

3 Theoretical Torque in Lb. Ft. per 100 PSI Differential Pressure

250/125/125

4 Shaft

N - No shaft & bearings

R - Solid shaft

5 Shaft Options

Keyed shaft when provided

6 Design

7 Features

Quiet feature, low pulsation levels

For satisfactory service life of these components, use full flow filtration to provide fluid which meets ISO cleanliness code 18/15 or cleaner. Selections from pressure, return, and in-line filter series are recommended.