

Service Data

Vickers®

Vane Pumps



High Pressure, High Performance Double Vane Pump

4525VPF Series -21 Design

To reverse Cartridge rotation remove Retaining Ring and Bearing Carrier S/A. Install Bearing Carrier S/A and Retaining Ring in opposite end of Cartridge and reinstall Cartridge facing in opposite direction. For R.H. rotation the end of the Cartridge with screw heads showing will be installed toward the cover end. For L.H. rotation the end of the Cartridge with screw heads showing will be installed toward the shaft end.

Model Code (Cover End)	● Cartridge Kit Standard	● Cartridge Kit Viton®
4525VPF-**-010	02-319101	02-319102
4525VPF-**-016	02-319103	02-319104
4525VPF-**-025	02-319105	02-319106
4525VPF-**-032	02-319107	02-319108
4525VPF-**-040	02-319109	02-319110
4525VPF-**-050	02-319111	02-379112
4525VPF-**-063	02-319113	02-319114
4525VPF-**-071	02-319115	02-319116
4525VPF-**-080	02-319117	02-319118

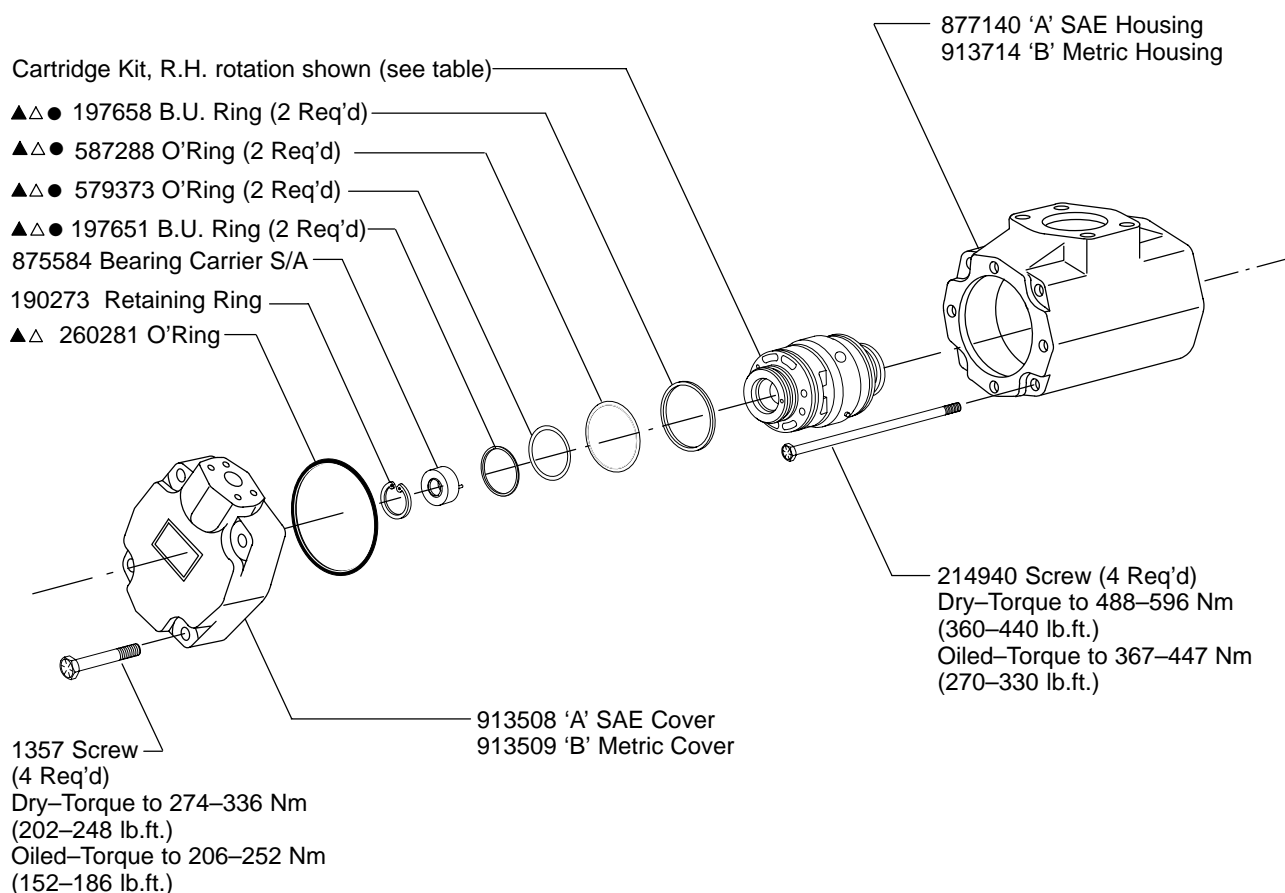

Parts prefixed with symbols are available only in kits.

▲ Available in 02-160546 Std Seal Kit, Single Shaft Seal or 02-160547 Viton® Seal Kit, Single Shaft Seal only.

△ Available in 02-160548 Std Seal Kit, Double Shaft Seal or 02-160549 Viton® Seal Kit, Double Shaft Seal only.

★ Included in Flange Kits (see table).

● Included in Cartridge Kits (see table).

Viton® is a registered trademark of the E.I. DuPont Co.

NOTE: Lubricate all parts and seals with a thin coat of oil at assembly.

Shaft Seal Options

A – Primary seal only: spring loaded sealing member facing inward.

B – Primary and secondary seals: primary seal with spring loaded sealing member facing inward and secondary seal with spring loaded sealing member facing outward.

C – Primary and secondary seals: both with spring loaded sealing member facing inward.

Model Code (Shaft End)	● Cartridge Kit Standard	● Cartridge Kit Viton®
4525VPF-140-***	02-322069	02-322070
4525VPF-160-***	02-322071	02-322072
4525VPF-180-***	02-322073	02-322074
4525VPF-195-***	02-322075	02-322076

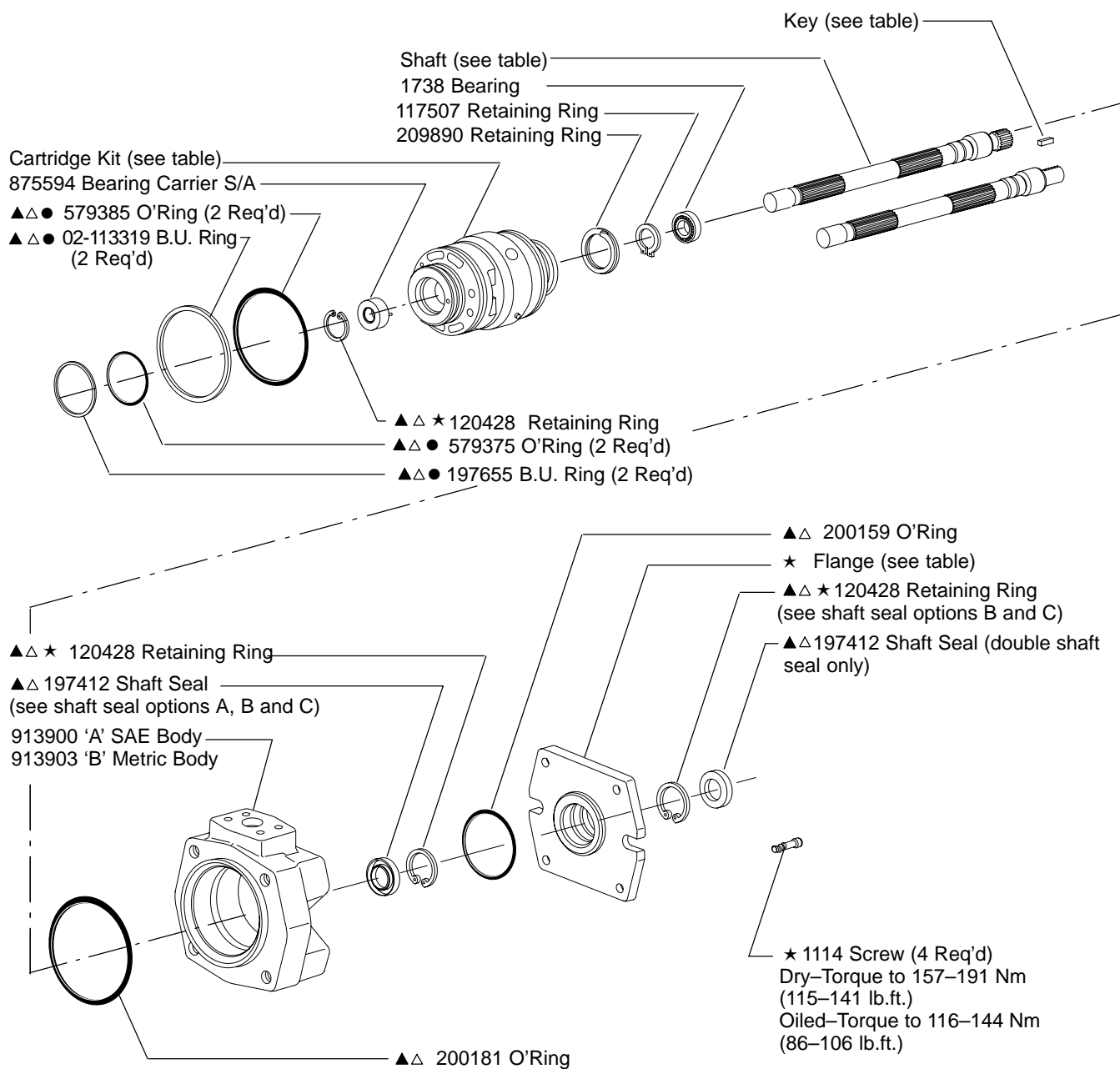

Flange Type	★ Flange Kit	
	Single Shaft Seal	Double Shaft Seal
SAE J744-127-2 (SAE C)	02-142497	02-142501
ISO 3019/2-125A2HW	02-142498	02-142502
SAE J744 152-2 (SAE D)	02-142499	02-142503
ISO 3019/2-160A2HW	02-142500	02-14250

Model Code	Shaft	Key
4525VPF-***-***-**-01	928535	928542
4525VPF-***-***-**-02	928536	—
4525VPF-***-***-**-03	928537	928547
4525VPF-***-***-**-05	928557	928543
4525VPF-***-***-**-06	877138	—

Model Code

4525VPF - * - *** - * - * - * - * - * - * - * - * - * - * - 21 - ***

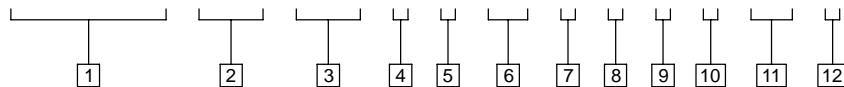

1 Series designation (frame size)

4525VPF – 150 to 275 cm³/r
(9.15 to 16.78 in³/r)

2 Displacement – front section

140 – 140 cm³/r (8.54 in³/r)
160 – 160 cm³/r (9.76 in³/r)
180 – 180 cm³/r (10.98 in³/r)
195 – 195 cm³/r (11.90 in³/r)

3 Displacement – rear section

010 –10 cm³/r (0.61 in³/r)
016 –16 cm³/r (0.97 in³/r)
025 –25 cm³/r (1.52 in³/r)
032 –32 cm³/r (1.95 in³/r)
040 –40 cm³/r (2.44 in³/r)
050 –50 cm³/r (3.05 in³/r)
063 –63 cm³/r (3.84 in³/r)
071 –71 cm³/r (4.33 in³/r)
080 –80 cm³/r (4.88 in³/r)

4 Port connection

A – SAE 4-bolt flange
B – Metric 4-bolt flange

5 Flange mounting style

A – SAE J744 127–2 (SAE C)
B – ISO 3019/2 125A2HW
C – SAE J744 152–2 (SAE D)
D – ISO 3019/2 160A2HW

6 Shaft

01 – SAE J744 32–1
(1.25 in keyed shaft)
02 – SAE J744 32–4
(C splined shaft)
03 – ISO 3019/2 E32N
(32mm keyed shaft)
05 – SAE J744 38–1
(1.50 in keyed shaft)
06 – SAE J744 38–4
(C–C splined shaft)

7 Shaft seal

A – Single, primary (spring side in)
B – Double, secondary (spring side out)
C – Double, secondary (spring side in)

8 Seal type

N – Standard, Buna N
V – Viton®
W – Buna N with Viton® shaft seal(s)

9 Outlet port no. 1 position (viewed from cover end)

A – Opposite inlet port
B – 90° counterclockwise from inlet port
C – Inline with inlet port
D – 90° clockwise from inlet port

10 Outlet port no. 2 position (viewed from cover end)

A – 135° counterclockwise from inlet port
B – 45° counterclockwise from inlet port
C – 45° clockwise from inlet port
D – 135° clockwise from inlet port

11 Design

12 Rotation (viewed from shaft end)

R – Right hand (clockwise)
L – Left hand (counterclockwise)

Viton® is a registered trademark of the E.I. DuPont Co.

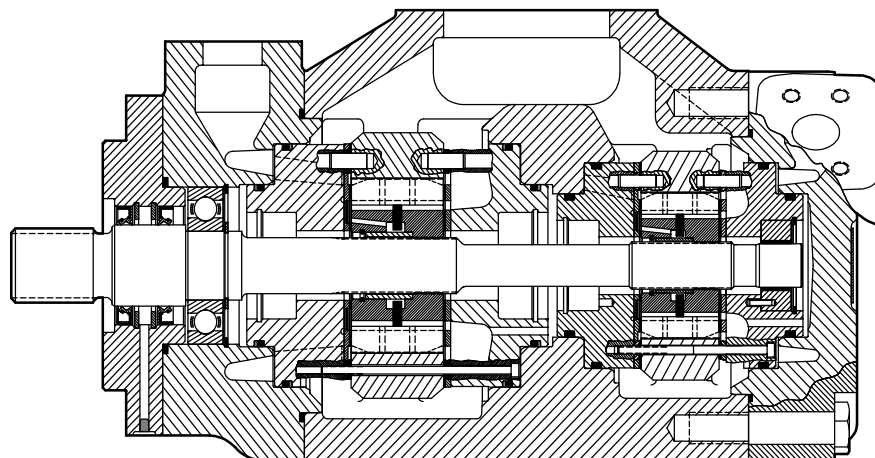

Typical sectional view

Eaton Hydraulics

15151 Highway 5
Eden Prairie, MN 55344
Telephone: 612 937-7254
Fax: 612 937-7130
www.eatonhydraulics.com

46 New Lane, Havant
Hampshire PO9 2NB
England
Telephone: (44) 170-548-6451
Fax: (44) 170-548-7110

