

Service Data

**Vickers®**

# Vane Pumps

---



## Double Vane Pump

4520VSH 42 A 5 F 412 \*\* 10



Revised 07-01-89

M-2516-S

CAPACITY (GPM) COVER END PUMP	● ROTOR	● VANE KIT	● RING	● INLET PLATE	● CARTRIDGE KIT
5	402690	922741	333624	584383	585471
8	403539	922743	875509	584384	875510

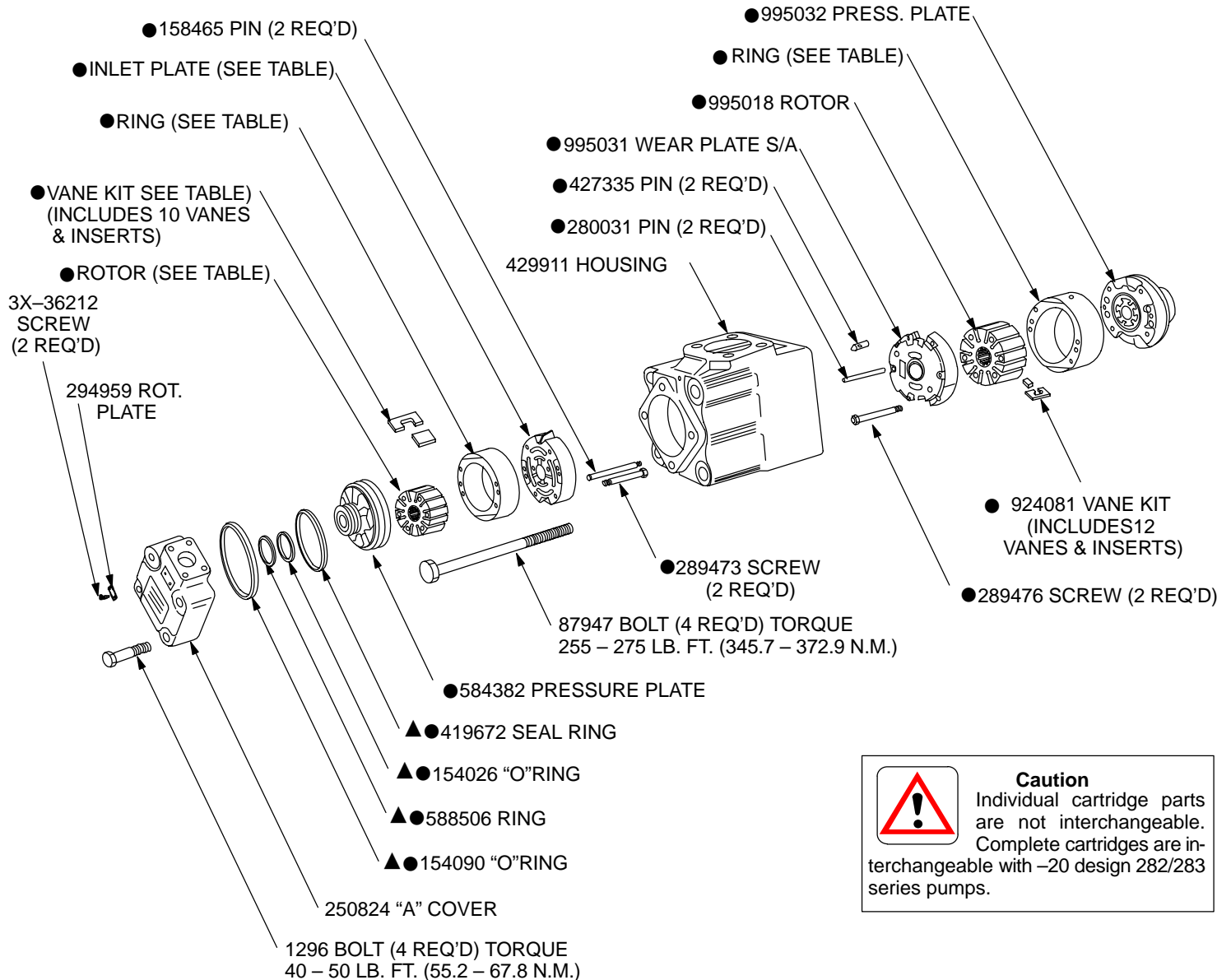



**Caution**  
Individual cartridge parts  
are not interchangeable.  
Complete cartridges are in-  
terchangeable with –20 design 282/283  
series pumps.

● INCLUDED IN CARTRIDGE KIT

▲ INCLUDED IN SEAL KIT 875838

◇ INCLUDED IN FB-C-10/12

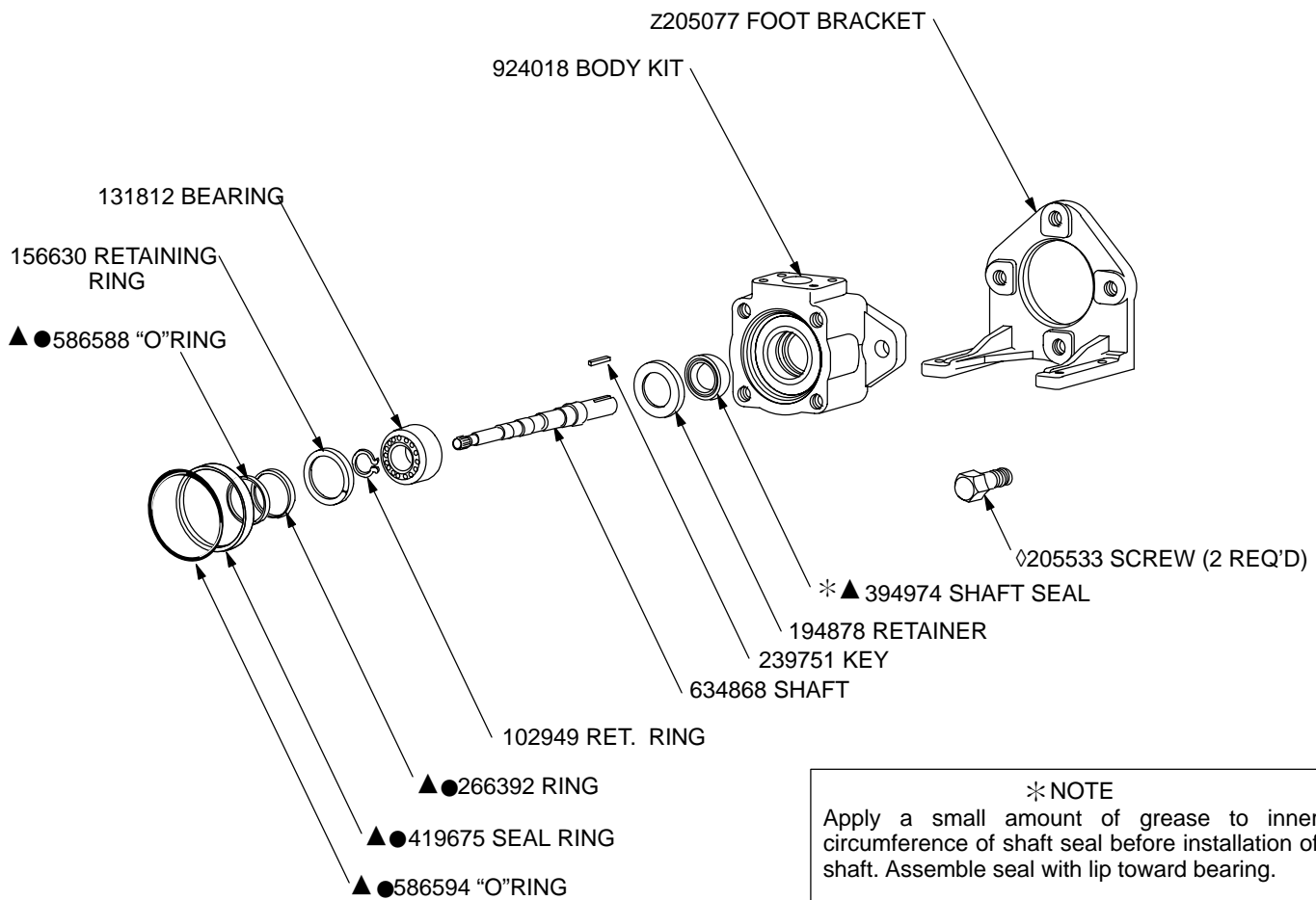

CAPACITY (GPM) SHAFT END PUMP	● RING	● CARTRIDGE KIT
42	581679	995013
50	581680	995014
60	578904	995015

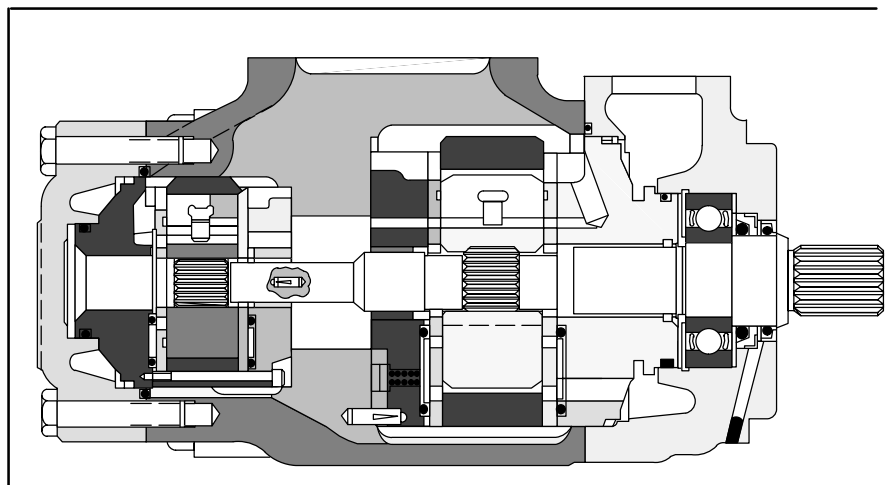

# MODEL CODE BREAKDOWN

**4520 VSH 42 A 5 F \*\*\* \*\* 10 L**

**1 2 3 4 5 6 7 8 9 10**

**1** Series  
(4520 Double Pump)

**2** Intra-Vane Pump  
(VSH Series)

**3** US GPM Capacity  
(Shaft End Pump)

SAE Rating 1200 RPM–100 PSI (7 Bar)

42 – 42 GPM 60 – 60 GPM

50 – 50 GPM

**4** SAE Port Connections

Code	Inlet	Outlet # 1	Outlet # 2
A	4-Bolt Flg.	4-Bolt Flg.	4-Bolt Flg.
E	4-Bolt Flg.	4-Bolt Flg.	SAE ST. Thd.

**5** US GPM Capacity  
(Cover End Pump)

SAE Rating 1200 RPM–100 PSI (7 Bar)

5 – 5 GPM 8 – 8 GPM

**6** Mounting

F – Foot  
Omit – Flange

**7** Shaft Type  
412 – STR. Key

**8** Outlet Port Positions  
(Viewed From Cover End Of Pump)

With No. 1 Outlet Opposite Inlet :

AA – No. 2 Outlet – 135° CCW From Inlet

AB – No. 2 Outlet – 45° CCW From Inlet

AC – No. 2 Outlet – 45° CW From Inlet

AD – No. 2 Outlet – 135° CW From Inlet

With No. 1 Outlet 90° CCW From Inlet :

BA – No. 2 Outlet – 135° CCW From Inlet

BB – No. 2 Outlet – 45° CCW From Inlet

BC – No. 2 Outlet – 45° CW From Inlet

BD – No. 2 Outlet – 135° CW From Inlet

With No. 1 Outlet Inline With Inlet :

CA – No. 2 Outlet – 135° CCW From Inlet

CB – No. 2 Outlet – 45° CCW From Inlet

CC – No. 2 Outlet – 45° CW From Inlet

CD – No. 2 Outlet – 135° CW From Inlet

With No. 1 Outlet 90° CW From Inlet :

DA – No. 2 Outlet – 135° CCW From Inlet

DB – No. 2 Outlet – 45° CCW From Inlet

DC – No. 2 Outlet – 45° CW From Inlet

DD – No. 2 Outlet – 135° CW From Inlet

**9** Design

**10** Shaft Rotation  
(Viewed From Shaft End)  
L – Left Hand (CCW Rotation)  
Omit – Right Hand (CW Rotation)

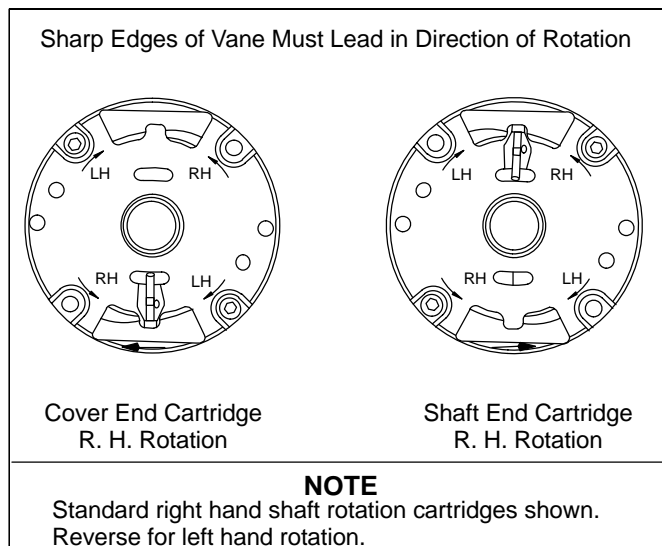

## NOTE

To reverse cartridge kit rotation, remove the two screws and reverse the location of the inlet support plate and the outlet support plate. Reinstall the two screws hand tight. Use pump cover to align all sections of the cartridge. Carefully remove the cover and tighten the screws.

When ordering spare cartridge parts, it is recommended they be obtained in cartridge kits. Kits are assembled and tested for either right or left hand rotation. If left hand rotation is required, it should be specified on parts order by adding suffix "L" to cartridge kit number.

For satisfactory service life of these components, use full flow filtration to provide fluid which meets ISO cleanliness code 18/15 or cleaner. Selections from OFP, OFR, and OFRS filter series are recommended.