

Service Data

Vickers®

Vane Pumps



Double Vane Pump

3520VSH 25 A 5 F 86 ** 10



Revised 07-01-89

M-2515-S

CAPACITY (GPM) COVER END PUMP	● ROTOR	● VANE KIT	● RING	● INLET PLATE	● CARTRIDGE KIT
5	402690	922741	333624	584383	585471
8	403539	922743	875509	584384	875510

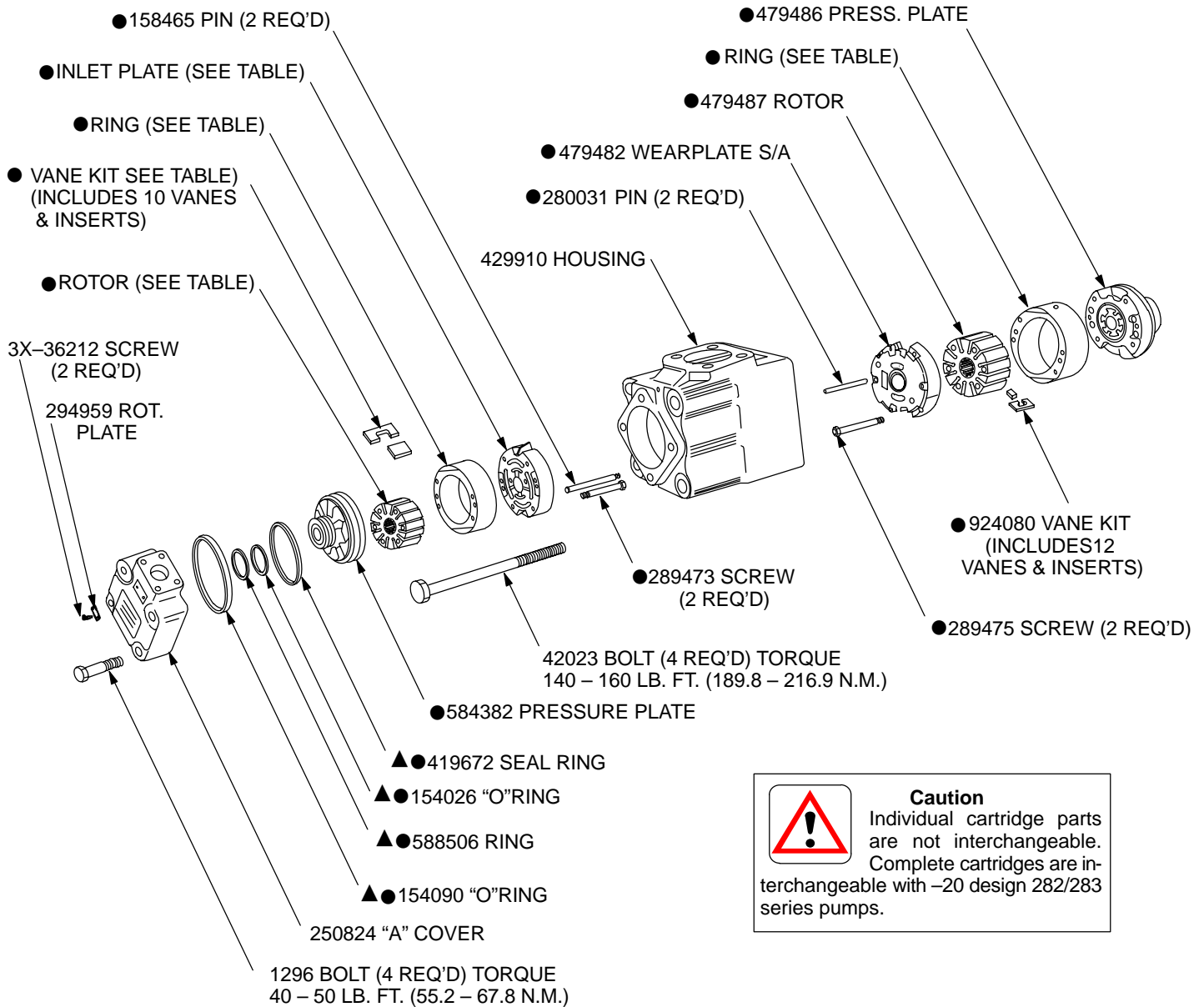

Caution
Individual cartridge parts
are not interchangeable.
Complete cartridges are in-
terchangeable with –20 design 282/283
series pumps.

- INCLUDED IN CARTRIDGE KIT
- ▲ INCLUDED IN SEAL KIT 922859
- INCLUDED IN FB-C-10/12

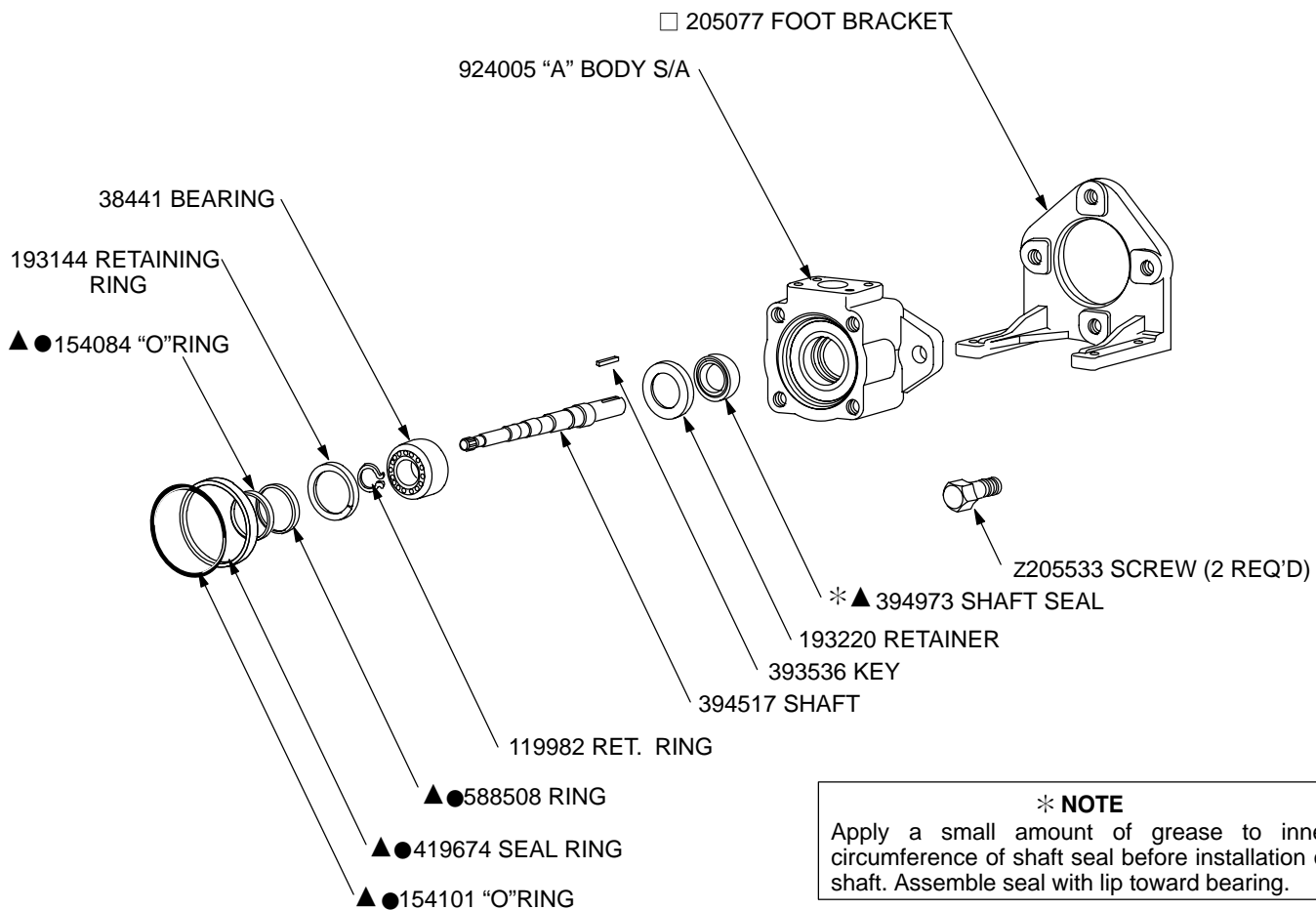

CAPACITY (GPM) SHAFT END PUMP	● RING	● CARTRIDGE KIT
25	576210	479474
30	576212	479475
35	576214	479476
38	575476	479477

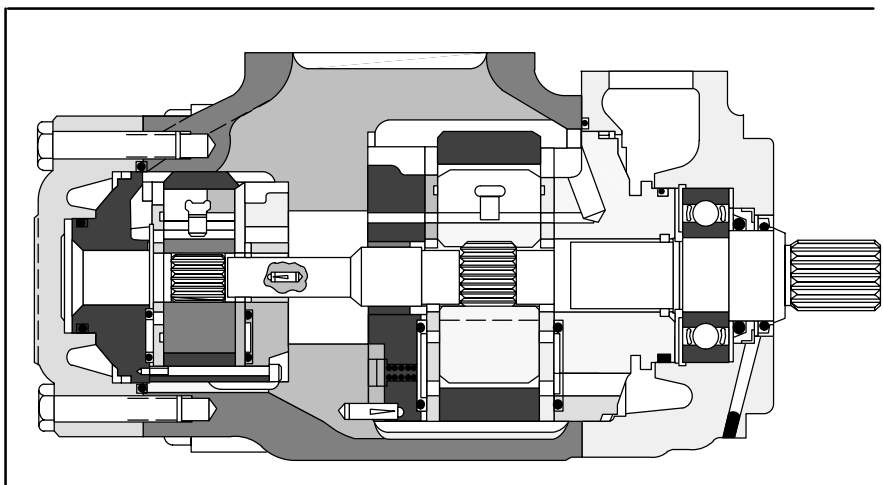

MODEL CODE BREAKDOWN

3520 VSH 25 A 5 F 86 ** 10 L

1 2 3 4 5 6 7 8 9 10

1 Series
(3520 Double Pump)

2 Intra-Vane Pump
(VSH Series)

3 US GPM Capacity
(Shaft End Pump)
SAE Rating 1200 RPM–100 PSI (7 Bar)
25 – 25 GPM 35 – 35 GPM
30 – 30 GPM 38 – 38 GPM

4 SAE Port Connections
Code Inlet Outlet # 1 Outlet # 2
A 4-Bolt Flg. 4-Bolt Flg. 4-Bolt Flg.
E 4-Bolt Flg. 4-Bolt Flg. SAE ST. Thd.

5 US GPM Capacity
(Cover End Pump)
SAE Rating 1200 RPM–100 PSI (7 Bar)
5 – 5 GPM 8 – 8 GPM

6 Mounting
F – Foot
Omit – Flange

7 Shaft Type
86 – STR. Key

8 Outlet Port Positions
(Viewed From Cover End Of Pump)

With No. 1 Outlet Opposite Inlet :
AA – No. 2 Outlet – 135° CCW From Inlet
AB – No. 2 Outlet – 45° CCW From Inlet
AC – No. 2 Outlet – 45° CW From Inlet
AD – No. 2 Outlet – 135° CW From Inlet

With No. 1 Outlet 90° CCW From Inlet :
BA – No. 2 Outlet – 135° CCW From Inlet
BB – No. 2 Outlet – 45° CCW From Inlet
BC – No. 2 Outlet – 45° CW From Inlet
BD – No. 2 Outlet – 135° CW From Inlet

With No. 1 Outlet Inline With Inlet :
CA – No. 2 Outlet – 135° CCW From Inlet
CB – No. 2 Outlet – 45° CCW From Inlet
CC – No. 2 Outlet – 45° CW From Inlet
CD – No. 2 Outlet – 135° CW From Inlet

With No. 1 Outlet 90° CW From Inlet :
DA – No. 2 Outlet – 135° CCW From Inlet
DB – No. 2 Outlet – 45° CCW From Inlet
DC – No. 2 Outlet – 45° CW From Inlet
DD – No. 2 Outlet – 135° CW From Inlet

9 Design

10 Shaft Rotation
(Viewed From Shaft End)
L – Left Hand (CCW Rotation)
Omit – Right Hand (CW Rotation)

Sharp Edges of Vane Must Lead in Direction of Rotation

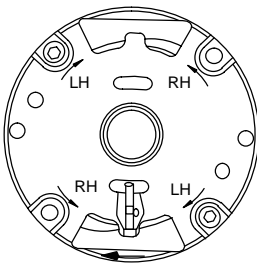

Cover End Cartridge
R. H. Rotation

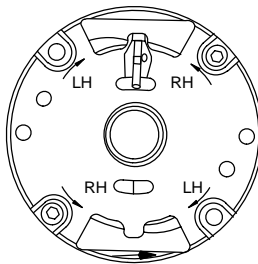

Shaft End Cartridge
R. H. Rotation

NOTE

Standard right hand shaft rotation cartridges shown.
Reverse for left hand rotation.

NOTE

To reverse cartridge kit rotation, remove the two screws and reverse the location of the inlet support plate and the outlet support plate. Reinstall the two screws hand tight. Use pump cover to align all sections of the cartridge. Carefully remove the cover and tighten the screws.

When ordering spare cartridge parts, it is recommended they be obtained in cartridge kits. Kits are assembled and tested for either right or left hand rotation. If left hand rotation is required, it should be specified on parts order by adding suffix "L" to cartridge kit number.

For satisfactory service life of these components, use full flow filtration to provide fluid which meets ISO cleanliness code 18/15 or cleaner. Selections from OFP, OFR, and OFRS filter series are recommended.