

Vane Pumps

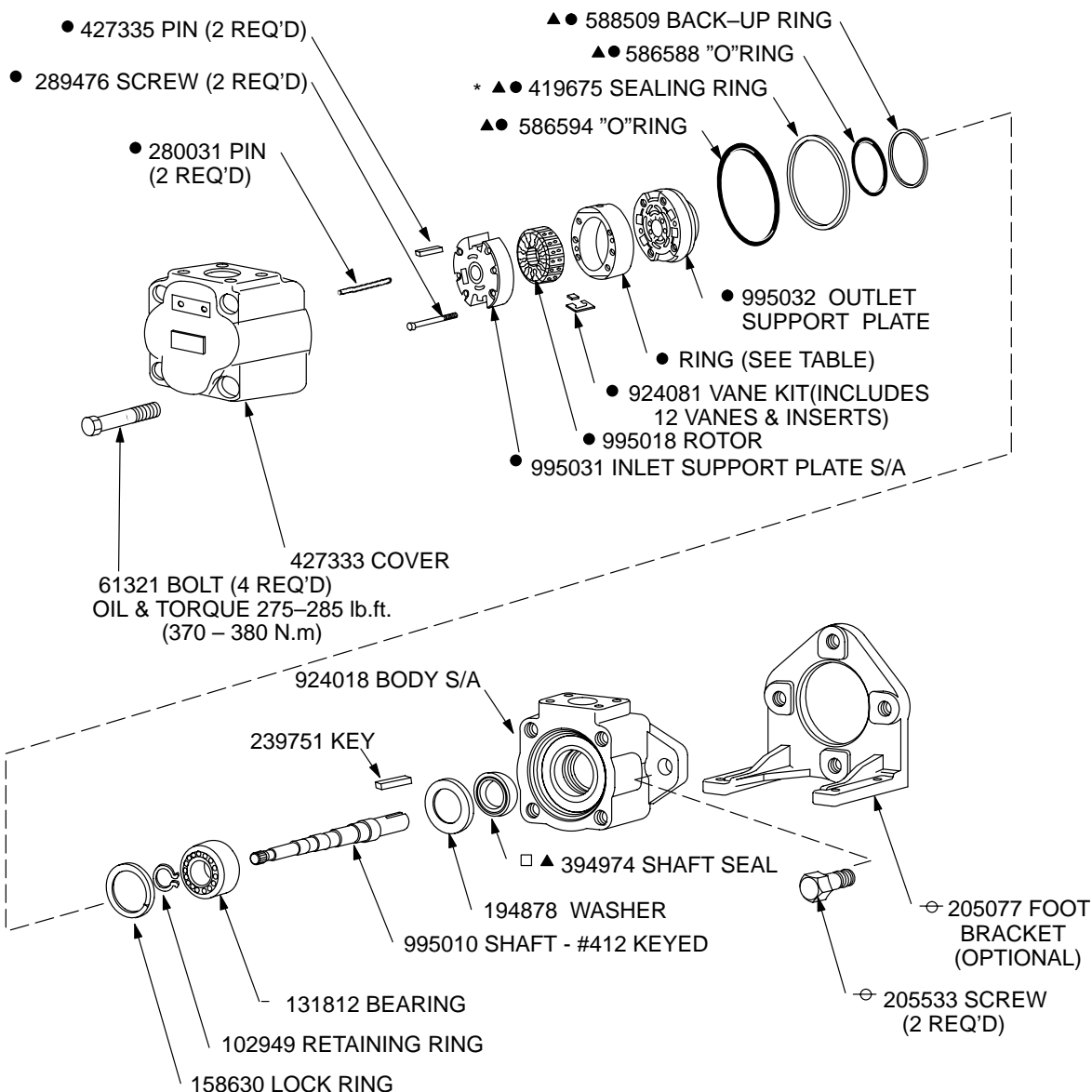

Vane Type Single Pumps

45VSH-**A*-***-10(L)



- INCLUDED IN CARTRIDGE KIT
- ▲ INCLUDED IN SEAL KIT 919850
- ⊕ INCLUDED IN FOOT BRACKET KIT FB-C-10
- ASSEMBLE SEAL WITH SPRING LOADED SEALING MEMBER TOWARDS BEARING. SEALS TO BE COMPLETELY WETTED WITH OIL PRIOR TO ASSEMBLY.
- * INSTALL 419675 SEALING RING INTO BODY, THEN INSTALL CARTRIDGE KIT.

MODEL (USGPM)	RING	CARTRIDGE KIT
42	581679	995013
50	581680	995014
60	578904	995015

MODEL CODE BREAKDOWN

45VSH 42 A F * A 10 L

1 2 3 4 5 6 7 8

1 Series
45VSH (Intra-Vane Type Pump)

2 US GPM Capacity
(SAE RATING 1200 RPM–100 PSI)
(SAE RATING 1200 RPM–7 bar)
42, 50, 60

3 SAE Port Connections
Code Inlet Outlet
A – 4-BOLT FLG. 4-BOLT FLG.

4 Mounting
F – Foot
Omit – Flange

5 Shaft Type
412 – Str. Key

6 Outlet Positions
(Viewed from cover end of pump)
A – Outlet – Opposite Inlet
B – Outlet – 90° CCW from Inlet
C – Outlet – Inline with Inlet
D – Outlet – 90° CW from Inlet

7 Design
10

8 Shaft Rotation
(Viewed from shaft end)
L – Left Hand (CCW Rotation)
Omit – Right Hand (CW Rotation)

Sharp Edges of Vane Must Lead in Direction of Rotation

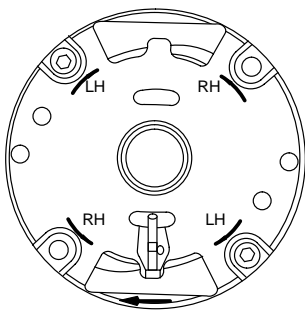

Cover End Cartridge
R. H. Rotation

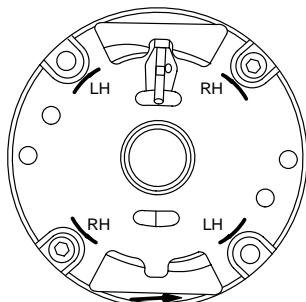

Shaft End Cartridge
R. H. Rotation

NOTE

Standard right hand shaft rotation cartridges shown.
Reverse for left hand rotation.

NOTE

To reverse cartridge kit rotation, remove the two screws and reverse the location of the inlet support plate and outlet support plate. Re-install the two screws hand tight. Use pump cover to align all sections of the cartridge. Carefully remove the cover and tighten the screws.

When ordering spare cartridge parts, it is recommended they be obtained in cartridge kits. Kits are assembled and tested by Vickers for either right or left hand rotation. If left hand rotation is required, it should be specified on parts order by adding suffix "L" to cartridge kit number.

For satisfactory service life of these components, use full flow filtration to provide fluid which meets ISO cleanliness code 18/15 or cleaner. Selections from Eaton OFP, OFR and OFRS filter series are recommended.