

# Vane Pumps

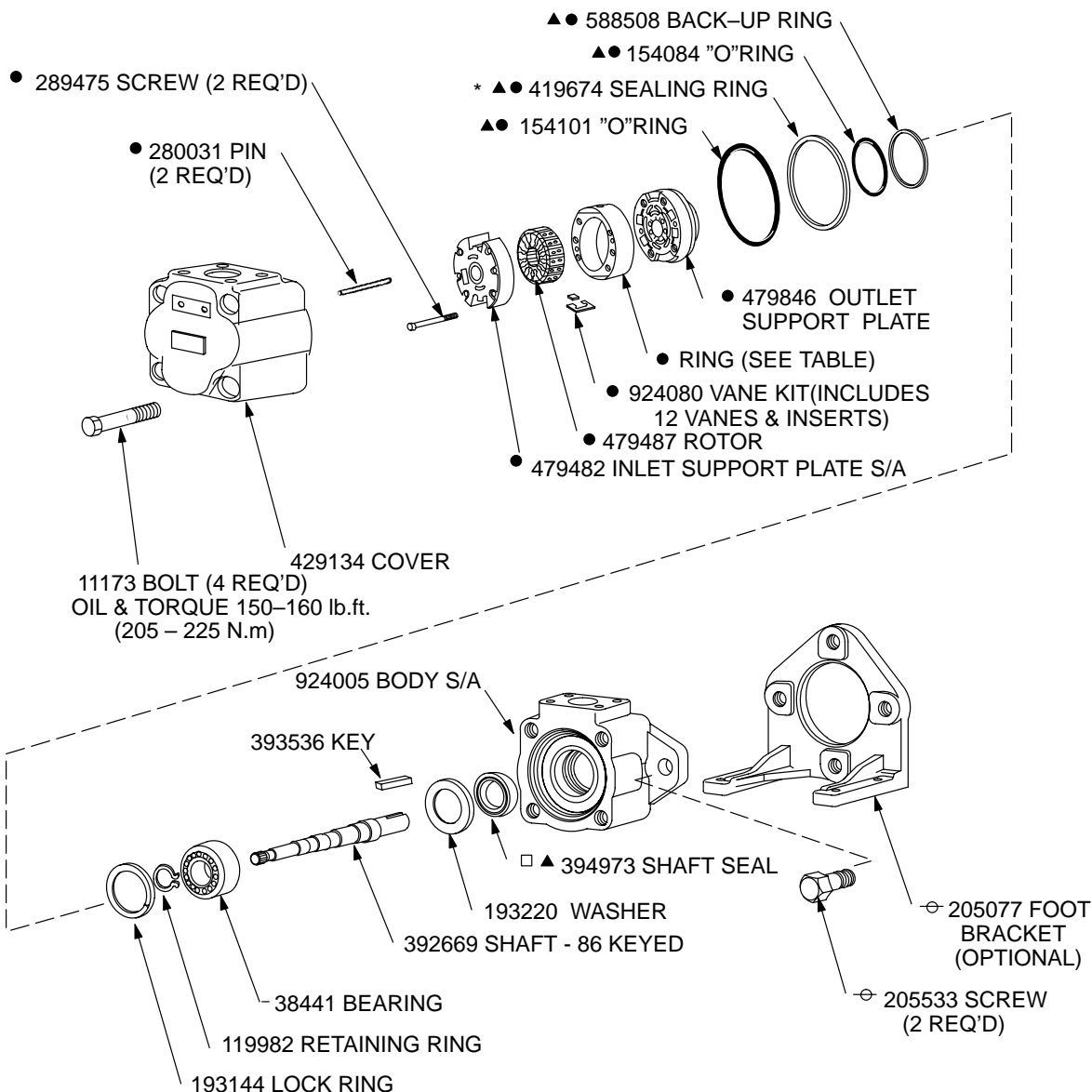

## Vane Type Single Pumps

35VSH-\*\*A\*-\*\*\*-10(L)



- INCLUDED IN CARTRIDGE KIT
- ▲ INCLUDED IN SEAL KIT 922851
- ⊕ INCLUDED IN FOOT BRACKET KIT FB-C-10
- ASSEMBLE SEAL WITH SPRING LOADED SEALING MEMBER TOWARDS BEARING. SEALS TO BE COMPLETELY WETTED WITH OIL PRIOR TO ASSEMBLY.
- \* INSTALL 419674 SEALING RING INTO BODY, THEN INSTALL CARTRIDGE KIT.

MODEL (USGPM)	RING	CARTRIDGE KIT
25	576210	479474
30	576212	479475
35	576214	479476
38	575476	479477

# MODEL CODE BREAKDOWN

**35VSH 25 A F \* A 10 L**

1 2 3 4 5 6 7 8

1 Series  
35VSH (Intra-Vane Type Pump)

2 US GPM Capacity  
(SAE RATING 1200 RPM–100 PSI)  
(SAE RATING 1200 RPM–7 bar)  
25, 30, 35, 38

3 SAE Port Connections  
Code Inlet Outlet  
A – 4-BOLT FLG. 4-BOLT FLG.

4 Mounting  
F – Foot  
Omit – Flange

5 Shaft Type  
86 – Str. Key

6 Outlet Positions  
(Viewed from cover end of pump)  
A – Outlet – Opposite Inlet  
B – Outlet – 90° CCW from Inlet  
C – Outlet – Inline with Inlet  
D – Outlet – 90° CW from Inlet

7 Design  
10

8 Shaft Rotation  
(Viewed from shaft end)  
L – Left Hand (CCW Rotation)  
Omit – Right Hand (CW Rotation)

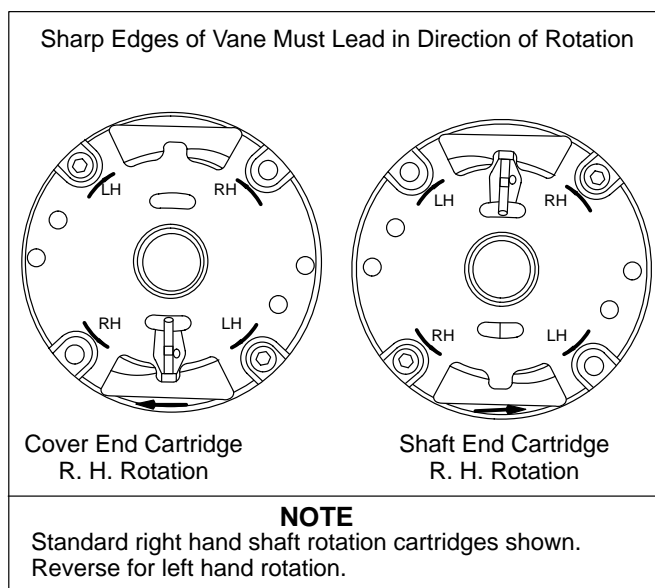

## NOTE

To reverse cartridge kit rotation, remove the two screws and reverse the location of the inlet support plate and outlet support plate. Re-install the two screws hand tight. Use pump cover to align all sections of the cartridge. Carefully remove the cover and tighten the screws.

When ordering spare cartridge parts, it is recommended they be obtained in cartridge kits. Kits are assembled and tested by Vickers for either right or left hand rotation. If left hand rotation is required, it should be specified on parts order by adding suffix "L" to cartridge kit number.

For satisfactory service life of these components, use full flow filtration to provide fluid which meets ISO cleanliness code 18/15 or cleaner. Selections from Vickers OFF, OFR and OFRS filter series are recommended.