

Vane Pumps

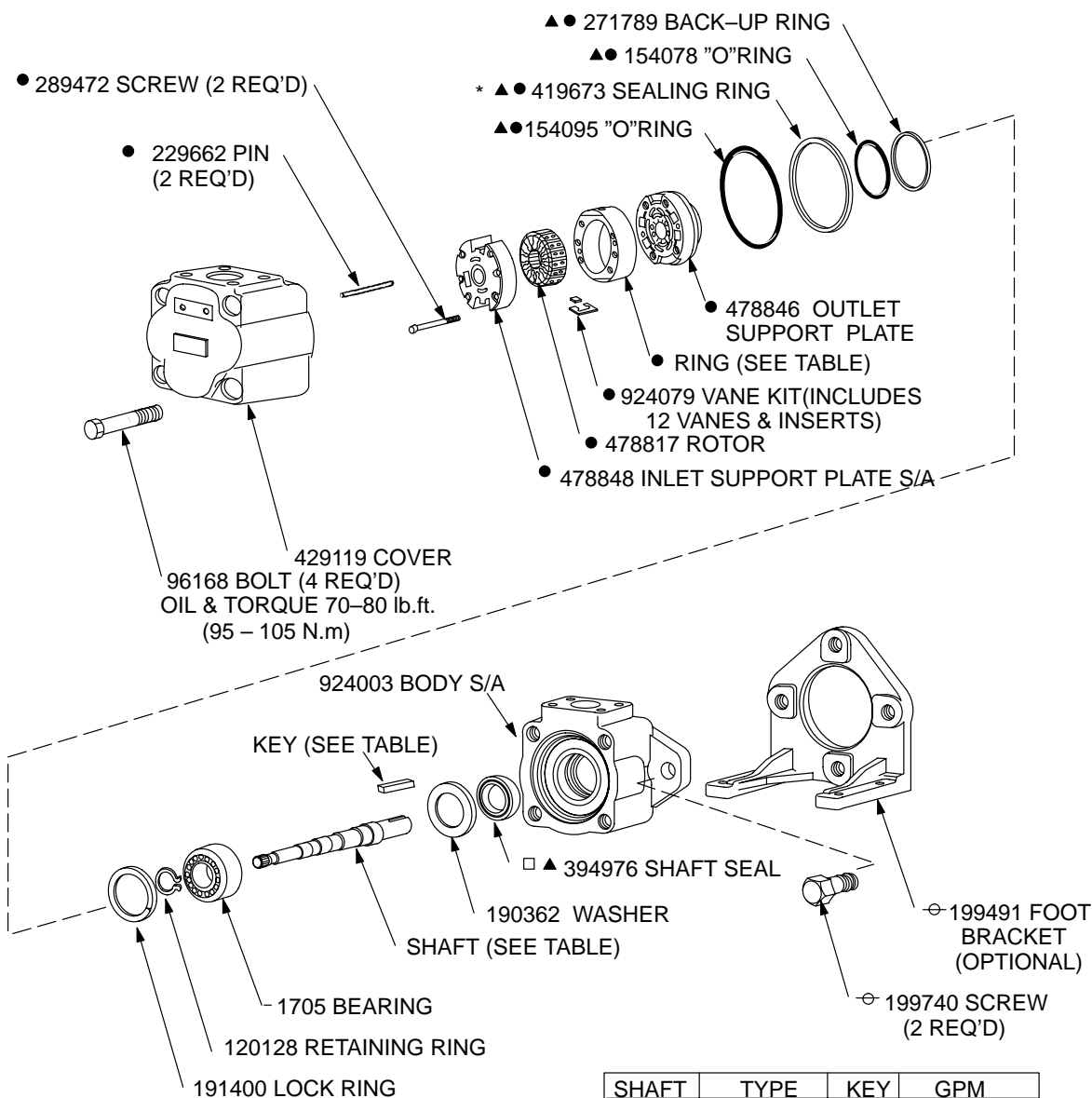

Vane Type Single Pumps

25VSH-**A*-***-10(L)



- INCLUDED IN CARTRIDGE KIT
- ▲ INCLUDED IN SEAL KIT 922850
- ⊖ INCLUDED IN FOOT BRACKET KIT FB-B-10
- ASSEMBLE SEAL WITH SPRING LOADED SEALING MEMBER TOWARDS BEARING. SEALS TO BE COMPLETELY WETTED WITH OIL PRIOR TO ASSEMBLY.
- * INSTALL 419673 SEALING RING INTO BODY, THEN INSTALL CARTRIDGE KIT.

SHAFT	TYPE	KEY	GPM
238755	(1)KEYED	9955	12/14
478826	(86) KEYED	3418	12/14/17/21

MODEL (USGPM)	RING	CARTRIDGE KIT
12	584610	478813
14	584612	478814
17	584514	478815
21	584616	478816

MODEL CODE BREAKDOWN

25VSH 12 A F * A 10 L

1 2 3 4 5 6 7 8

1 Series
(Intra-Vane Type Pump)

25VSH

2 US GPM Capacity
(SAE RATING 1200 RPM–100 PSI)
(SAE RATING 1200 RPM–7 bar)

12,14,17,21

3 SAE Port Connections

Code	Inlet	Outlet
A –	4-BOLT FLG.	4-BOLT FLG.

4 Mounting

F – Foot
Omit – Flange

5 Shaft Type

1 – Str. Key (12 and 14 USGPM ONLY)
86 – Str. Key

6 Outlet Positions
(Viewed from cover end of pump)

A – Outlet – Opposite Inlet
B – Outlet – 90° CCW from Inlet
C – Outlet – Inline with Inlet
D – Outlet – 90° CW from Inlet

7 Design

10

8 Shaft Rotation
(Viewed from shaft end)

L – Left Hand (CCW Rotation)
Omit – Right Hand (CW Rotation)

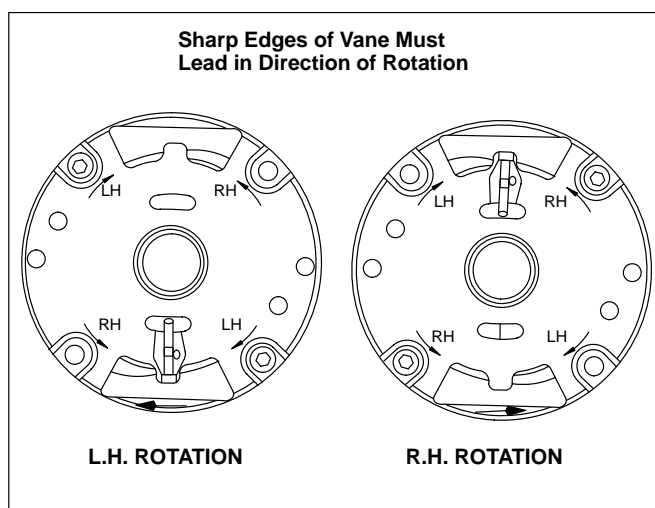

NOTE

To reverse cartridge kit rotation, remove the two screws and reverse the location of the inlet support plate and outlet support plate. Re-install the two screws hand tight. Use pump cover to align all sections of the cartridge. Carefully remove the cover and tighten the screws.

When ordering spare cartridge parts, it is recommended they be obtained in cartridge kits. Kits are assembled and tested by Vickers for either right or left hand rotation. If left hand rotation is required, it should be specified on parts order by adding suffix "L" to cartridge kit number.

For satisfactory service life of these components, use full flow filtration to provide fluid which meets ISO cleanliness code 18/15 or cleaner. Selections from Vickers OFF, OFR and OFRS filter series are recommended.